

OIL FILTER BY-PASS ADAPTERS

For Use in By-Passing Standard Oil Filter to Install Remote Filter System

FORD V-8



332, 351, 390, 406, 427 and 428 cu. in. engines.

Catalog No.
12350

Item No.
48

CHRYSLER B - 1959 -1979 AND FORD 1957 AND LATER



221, 260, 289, 292, 302, 312, 351, 400, 429 and 460 cu. in.

Catalog No.
12380

Item No.
51

CHEVROLET AND PONTIAC



1968 and later Chevrolet and 1971-72 Pontiac V-8s with spin-on oil filters.

Catalog No.
12390

Item No.
52

OLDSMOBILE



350, 425 and 455 cu. in.
For spin-on type filters.

Catalog No.
12395

Item No.
1660

FLYWHEEL POWER TAKE-OFFS

FLYWHEEL POWER TAKE-OFFS

STEEL

Precision drilled and tapped to receive 1310 or 1350 drive lines. Bolts to the flywheel or flexplate, bolt pack included. To determine drive line series, measure the registration (see photo at right).



1310 Series Male Pilot - 2-3/8"

1350 Series Male Pilot - 2-3/4"

1310 DRIVE LINE SERIES

Drive Line	Catalog No.	Item No.
Chevy - PG	32710	793-E
Chevy - Standard	32710	793-F
Chrysler 6 Bolt	32710	793-G
Chrysler 8 Bolt	32710	793-H
272-312 Ford	32710	793-I
289-351 Ford	32710	793-J
331-460 Ford	32710	793-K
65 Olds (425 c.i.)	32710	793-L
66-81 Olds (350-455 c.i.)	32710	793-M
59-64 Pontiac	32710	793-N
65-88 Pontiac	32710	793-O
Chevy (87 & newer) -PG	32710	793-P
Chevy (87 & newer) - Std	32710	793-Q
Chevy (81-86 V-6) - PG	32710	793-R
Chevy (81-86 V-6) - Std	32710	793-S

1350 DRIVE LINE SERIES

Drive Line	Catalog No.	Item No.
49-64 Cad/Oldsmobile	32750	796-D
Chevy - PG	32750	796-E
Chevy - Standard	32750	796-F
Chrysler 6 Bolt	32750	796-G
Chrysler 8 Bolt	32750	796-H
289-351 Ford	32750	796-J
331-460 Ford	32750	796-K
65 Olds (425 c.i.)	32750	796-L
66-81 Olds (350-455c.i.)*	32750	796-M
59-64 Pontiac	32750	796-N
65-88 Pontiac	32750	796-O
Chevy (87 & newer) -PG	32750	796-P
Chevy (87 & newer) - Std	32750	796-Q

*Not available for flex plate

CHEVROLET 1/2" SPACERS FOR AUTOMATIC FLYWHEEL FOR REVERSE ENTRY STARTERS

	Catalog No.	Item No.
Big Block Chevrolet	32710	793
Chevrolet (87)	32750	796

BORG WARNER POWER TAKE-OFF

STEEL

Made exclusively to fit Borg Warner Velvet Drive transmission for model 71 and 72 gears. Flange adapter is drilled and tapped to receive the 1310 or 1350 drive line series.

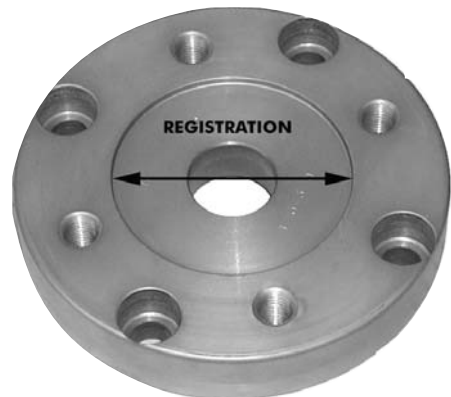

Drive Line Series	Catalog No.	Item No.
1310 for 71 Gear	32711	794
1350 for 71 Gear	32751	797
1310 for 72 Gear	32712	795
1350 for 72 Gear	32752	798

ADAPTERS

ENGINE ADAPTER

CAST ALUMINUM



Adapts to any of Glenwood's rear engine mounts to accommodate stainless steel tube. Has a 9½" O.D. and a 5" I.D. and is made to fit our S.S. Tubes.

Catalog No.
337500

Item No.
850

V-DRIVE ADAPTER

CAST ALUMINUM

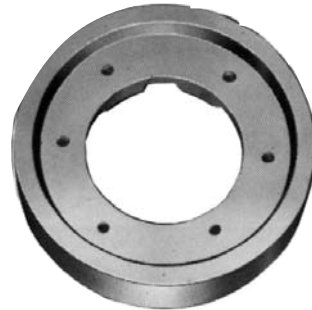

This adapter will fit all Casale V-drives. Has a precision machined flange to hold the tube adapter. Has a 5" O.D. and is made to fit our Tube Adapter Sleeve.

Catalog No.
337501

Item No.
851

ADAPTER FOR TURBO 400

CAST ALUMINUM



This adapter is made for a Turbo 400 short tail shaft transmission and made to fit our stainless steel tubes. Has a 4¾" O.D. and is made to fit our S.S. Tubes.

Catalog No.
337498

Item No.
1692

V-DRIVE ADAPTER - C-500

CAST ALUMINUM



This adapter will fit the C-500 Casale V-Drive. Has a precision machined flange to hold the tube adapter. Has a 5" O.D. and is made to fit our Tube Adapter Sleeve.

Catalog No.
337599

Item No.
1693

STEERING • ADAPTERS

CUSTOM RACING WHEELS



Three spoke dished steering wheel. Rim is double dipped foam and spokes are bright chrome. The perfect wheel for competition or fun.

Black only.

Diameter	Catalog No.	Item No.
12"	20220	414
13"	20221	415

COVICO CUSTOM STEERING WHEELS



High performance, deep dished steering wheel. Sturdy, non-corrosive polished stainless steel frame. **Black only.**

Diameter	Catalog No.	Item No.
13"	20222	2000
14"	20223	2010

CAP ASSEMBLY AND HUB ADAPTERS

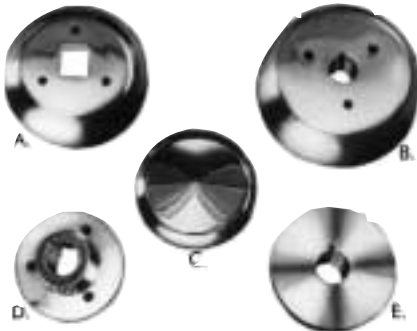

Description	Catalog No.	Item No.
C. Cap Assembly	20240	417

Adapters

A. Rideguide	20241	418
B. Teleflex	20242	419
E. Steermaster	20243	420
D. 3/4 Standard	20244	421
B. Attwood	20245	422
B. Morse	20246	423

FORMULING STEERING WHEEL HUB ADAPTERS



Solid aluminum construction, no castings. Available in polished and four anodized colors.

For Morse, Detroit Marine, Steermaster and Teleflex steering systems:

Catalog No.	Item No.
S-901 Polished	2200
S-901 Black	2210
S-901 Blue	2220
S-901 Gold	2230
S-901 Red	2240

For Rideguide Steering:

Catalog No.	Item No.
S-903 Polished	2300
S-903 Black	2310
S-903 Blue	2320
S-903 Gold	2330
S-903 Red	2340