

WATER DIVIDERS • THERMOSTAT KIT

WATER DISCHARGE DIVIDERS

CAST ALUMINUM



Ford 332-352-390-406-427 & 428 cu. in.

Polished aluminum alloy. Provides for equal discharge of water and easy connection of water hoses.

Catalog No.	Item No.
27023	683

WATER DISCHARGE DIVIDERS

CAST ALUMINUM



Allows water lines to be connected to water cooled exhaust manifolds or elbows with equal discharge rate.

	Catalog No.	Item No.
Chevrolet	27022	682
Oldsmobile	27024	684
Pontiac	27025	685

THERMOSTAT KIT

FOR CHEVROLET AND OLDSMOBILE

Maintain proper engine temperature with this engine thermostat kit. Featuring a special split-water intake and discharge housing. This system allows your engine to maintain optimum operating temperatures at all speeds (160° to 180°F). Thermostat kit comes complete with brass fittings. Housing is available in polished aluminum.

Catalog No.	Item No.
27030	1800



WATER PICK-UPS

MINIATURE WATER PICK-UP

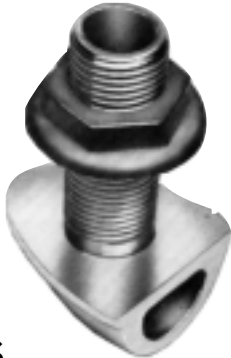

CAST BRASS

A small streamline fitting which may be used with centrifugal feed cooling to the V-Drive.

Pipe I.D.: 3/8"

Pipe Length: 1-5/8"

Description	Catalog No.	Item No.
Brass	19731	406
Chrome	19741	408

HIGH SPEED SCOOP STRAINERS



CAST BRASS

Water inlet fitting has a protective grate over the intake.

Pipe I.D	Pipe Length	Catalog No.	Item No.
1/2"	2-1/4"	30112	729
3/4"	2-9/16"	30134	730
1"	3"	30101	728

HIGH SPEED WATER PICK-UP



CAST BRASS

A pick-up which can be used with a pump or centrifugal feeding the block.

Pipe I.D.: 1/2"

Pipe Length: 2-1/4"

Description	Catalog No.	Item No.
Brass	30230	731
Chrome	30240	732

WATER DIVIDER TEE



CAST BRASS

This water divider is a must on V-8 engines to distribute an even flow of water to both cylinder heads. The inlet is tapped for 1/2" NPT and the outlets are for 5/8" hose.

Description	Catalog No.	Item No.
Brass	21130	465
Chrome	21140	466